

MC-Hyperstop Series

Hydrophilic rubber swelling waterstop combined with bentonite.

PRODUCT DESCRIPTION: **MC-Hyperstop Series** is a hydrophilic swelling waterstop made from modified butyl rubber combined with swelling bentonite. Upon contact with water, the product expands to seal gaps and capillaries at construction joints, creating pressure that effectively prevents water ingress. It is widely used in concrete construction joints in various structural applications.

- PRODUCT PROPERTIES:**
- Rapid swelling upon water contact.
 - Stable expansion performance, unaffected by wet/dry cycles.
 - High waterproofing efficiency in wet environments.
 - Easy installation, saving time and cost.
 - Durable and suitable for various applications.

- AREAS OF APPLICATION:** **MC-Hyperstop Series** is used at construction joints in:
- Foundation walls and basement walls;
 - Concrete slabs and structural elements;
 - Pipe penetrations through walls and slabs;
 - Manholes, water tanks, and treatment tanks;
 - Tunnels, bridges, and infrastructure works,...

- APPLICATION NOTES:**
- **Instructions for use:**
 - **MC-Hyperstop Series** is placed directly onto the concrete surface at construction joints.
 - It can be bonded or mechanically fixed before casting the next concrete layer.
 - For pipe penetrations, wrap around the pipe at the penetration location.
 - Ensure the product is securely fixed before concrete placement.
 - **Application method:**

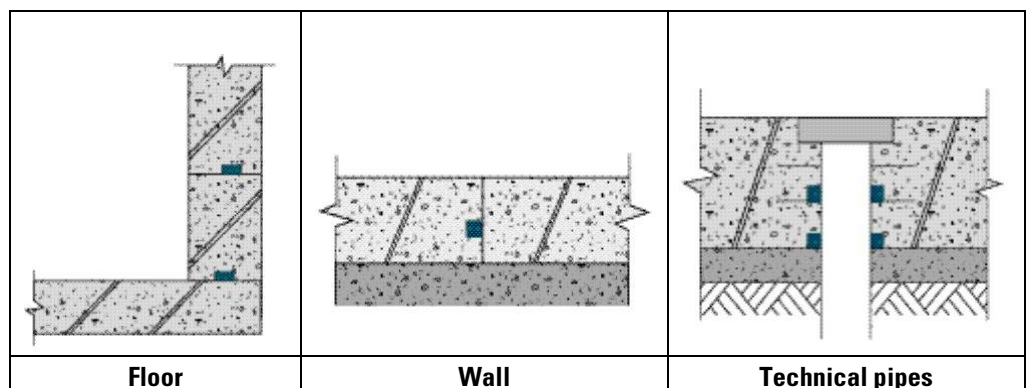

- **Notes:**
 - Store in dry conditions before installation
 - Avoid contact with water prior to application
 - Install at correct joint locations to ensure waterproofing performance
- **Technical support:** MC-BIFI provides on-site technical consultation and application guidance, along with recommending suitable waterproofing solutions for each specific application to ensure long-term performance and durability.

EXPANSION CHART:

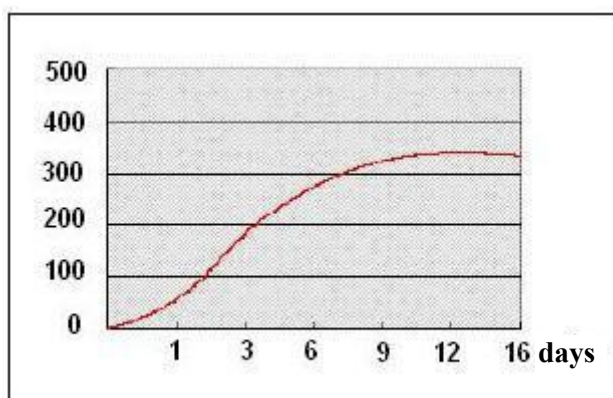

TECHNICAL DATA:

Characteristic	Unit	Value	Comments
Density at 25°C	g/cm ³	1.35 ± 0.10	ASTM D-71 / KS M 6519:2003
Dimensional tolerance	%	±5	
Appearance deformation		No abnormality	ASTM D-71/ KS M 6522:2006
Cold resistance		No abnormality	
Volume expansion	%	250	ASTM D-71/ KS M 6518:2006

PRODUCT CHARACTERISTICS:

Color	Black.
Available sizes	<ul style="list-style-type: none"> ▪ 20mm x 10mm (7m x 7,5m rolls/box) ▪ 20mm x 15mm (5m x 7 rolls/box) ▪ 25mm x 15mm (5m x 6 rolls/box) ▪ 25mm x 19mm (5m x 6 rolls/box) <p>The rolls all have a steel mesh reinforcement in the middle.</p>

Note: The information provided here is based on our experience and correct to the best of our knowledge. It is, however, not binding. It will need to be adapted to the requirements of the individual building projects, to the specific application and to non-standard local conditions. Our data refers to the accepted engineering rules, which have to be observed during application. Given these preconditions we shall be liable for the accuracy of the information given as outlined in our sales and delivery terms and conditions. Recommendations by our employees that deviate from this information are only binding for us if they have been confirmed in writing. In all cases, the generally accepted rules and practices reflecting the current state of the art must be adhered.

Edition **V1.24042026**. Some technical changes have been made to this print medium. Older editions are invalid and may not be used.